

Photodiode Lms24PD-03 #155-156

Lot Number K-2109-#51,52

All parameters refer to photodiode operation at ambient temperature 25°C unless otherwise stated.

TOTAL DEVICE	Symbol	Value	Units
Photodiode package	TO-18 with a cap without a glass window		
Sensitive area size	d	0.3	mm
Storage temperature	T _{stg}	-60 ... +90	°C
Operating temperature	T _{opr}	-60 ... +90	°C
Soldering temperature (can be applied for not more than 5 secs)	T _{sol}	+180	°C
PHOTODIODE			
Cut-off wavelength (at 10% level)	λ_{cut}	2.42-2.43	μm
Maximum sensitivity wavelength (at 80% level)	λ_p	1.85-2.30	μm

Parameter	Symbol	Units	Value	
Serial number			155	156
Shunt resistance (V _r = 10 mV) (at 25 °C)	R _{sh}	k Ω	47.6	46.5
Dark current (V _r = 1 V) (at 25 °C)	I _d	μA	6	7
Detectivity ($\lambda=2.2\mu\text{m}$) (at 25 °C)	D*	$\text{cm}\cdot\text{Hz}^{1/2}\cdot\text{W}^{-1}$	1.2E+11	1.2E+11
Noise equivalent power* ($\lambda=2.2\mu\text{m}$) (at 25 °C)	NEP	$\text{W}/\text{Hz}^{1/2}$	8.4E-13	8.3E-13

Spectral response

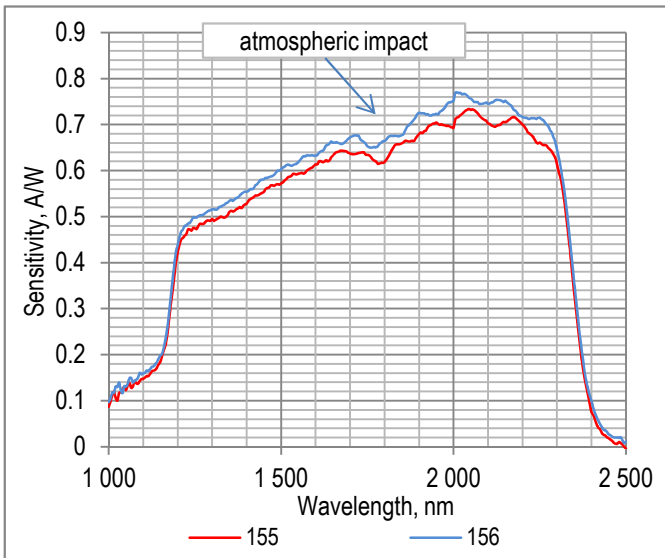

Typical Current Voltage characteristics

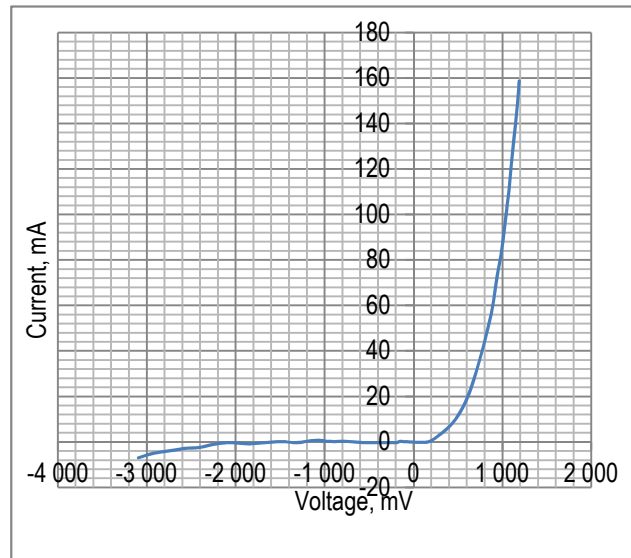

We recommend using **photovoltaic mode**, when PD is used under no reverse bias.
Use photoconductive mode (mode with reverse bias) with caution.

- Important cautions:**
- check your connection circuit before turning on the PD;
 - mind the PD polarity: PD anode is marked with a RED dot;
 - do not connect the PD to the multimeter;



아이티비코퍼레이션
 전화 : 02-549-8501
 팩스 : 02-549-8502
 전자우편 : sales@itbco.co.kr
 홈페이지 : www.itbco.co.kr

LED Microsensor NT, LLC.
 Post box 100,
 194223 Saint-Petersburg, Russia,
 info@lmsnt.com
 www.lmsnt.com

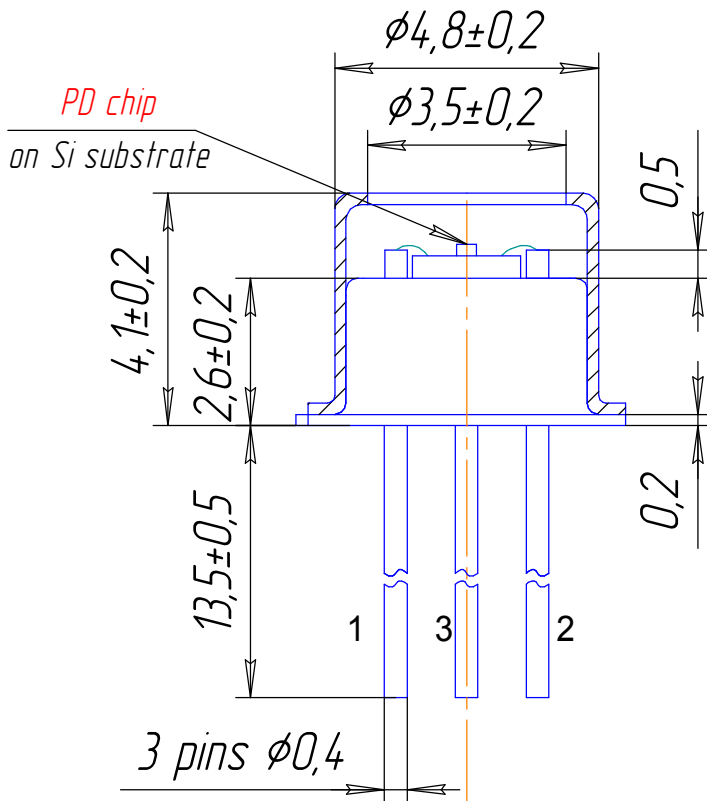

3 pins $\phi 0,4$

TOP VIEW

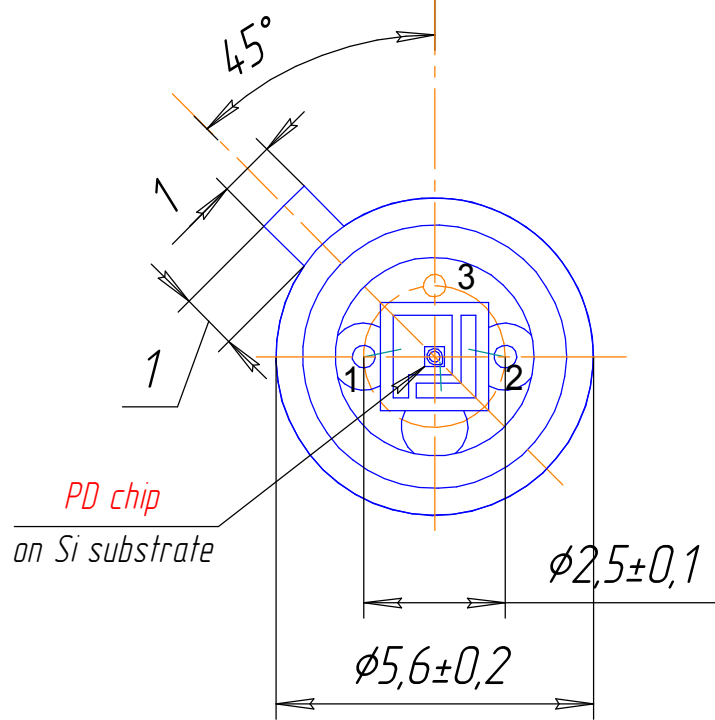

- 1 - PD cathode
- 2 - PD anode
- 3 - ground pin

